

SONY[®]



PLAYSTATION[®] ***3***

Wireless Headset
Instruction Manual

SCEH-00075
SCEH-00087

7012483

WIRELESS HEADSET INSTRUCTION MANUAL

CONTENTS

Wireless Headset

Charging cradle

USB cable

Replacement earpiece ring

PRECAUTIONS

Before using this product, carefully read this manual and retain it for future reference. Also refer to the instructions for your PLAYSTATION®3 system for further precautions and information.

USE AND HANDLING

- Stop using this product immediately if it causes discomfort or pain.
- Do not expose the product to high temperatures, high humidity or direct sunlight.
- Do not allow the product to come into contact with liquids.
- Do not put heavy objects on the product.
- Do not throw or drop this product, or physically damage it in any way.
- Do not touch or insert foreign objects into the connectors of this product.
- Do not attempt to disassemble or modify this product.
- Do not twist the supplied USB cable or pull it forcibly.
- When using this product, it is recommended that you limit volume to help avoid harm to your ears and danger resulting from being unable to hear what is going on around you.
- Do not place any rubber or vinyl materials on the product exterior for an extended period of time.
- Use a soft, dry cloth to clean the product. Do not use solvents or other chemicals. Do not wipe with a chemically treated cleaning cloth.
- Small parts. Not suitable for children under six years.

ABOUT THE WIRELESS HEADSET

1. Power button
2. Volume + button
3. Volume – button
4. Mic muting button
5. Mic muting indicator
6. Power indicator
7. Ear clip
8. Charging cradle

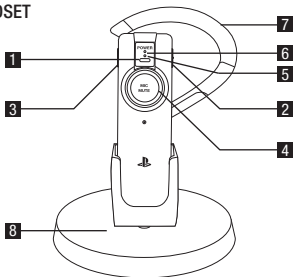

The Wireless Headset is designed to be used with the PLAYSTATION®3 system. It will also work with most Bluetooth®-enabled mobile phones and audio devices.

This Quick Start Guide will help you start using the Wireless Headset right away. For further reference, a full User Manual is available online at playstation.com

NOTE: Before using the Wireless Headset for the first time, it must be fully charged and “paired” with the PS3™ system. The USB connector on the Wireless Headset is protected by a cover which must be opened before the mini-B connector of the supplied USB cable can be inserted.

CHARGING THE WIRELESS HEADSET

1. Check that the PS3™ system is turned on.
2. Insert the mini-B connector of the supplied USB cable into the charging cradle, and insert the other end of the cable into a USB connector on the PS3™ system.
3. Place the Wireless Headset into the charging cradle. The mic muting indicator on the headset lights up and remains solid red for two seconds. It will then flash to indicate that the headset is charging. Charging is complete when the indicator stops flashing. You can also charge the Wireless Headset by connecting it directly to the PS3™ system or any powered USB port – such as on a PC – using a USB cable.

NOTE: The headset will be fully charged in approximately three hours.

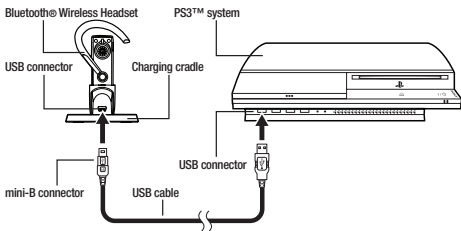

PAIRING THE WIRELESS HEADSET WITH THE PS3™ SYSTEM

To pair with the PS3™ system using a USB cable, your PS3™ system software must be updated to version 2.50 or higher. Additional features will be available on your headset when you update the PS3™ system software to version 2.50 or higher, but only if you pair your headset with the PS3™ system using a USB cable. These features will not be available if you pair using Bluetooth® Discovery Mode. Pairing using Bluetooth® Discovery Mode only allows you to use your headset in the same way as a standard Bluetooth® headset.

NOTE: Further information on pairing using Bluetooth® Discovery Mode can be found later in this manual.

PAIRING WITH THE PS3™ SYSTEM USING A USB CABLE

1. Check that the PS3™ system is turned on.
2. Insert the mini-B connector of the supplied USB cable directly into the USB connector on the Wireless Headset, and insert the other end of the cable into a USB connector on the PS3™ system.

The power indicator on the Wireless Headset lights up in solid green for two seconds to indicate that the headset and the PS3™ system have been successfully paired. If pairing is not successful, the headset's power indicator will remain lit in solid red for two seconds.

PAIRING WITH THE PS3™ SYSTEM IN BLUETOOTH® DISCOVERY MODE

1. Press and hold the power button on the Wireless Headset until the power indicator flashes alternately in green and red, indicating that Bluetooth® Discovery Mode is enabled.
2. On the PS3™ system's Home Menu, go to Settings, then Accessory Settings and select Manage Bluetooth® Devices.
3. An on-screen message will ask if you would like to register a Bluetooth® device. Select Yes when prompted.
4. Select Start Scanning. Your PS3™ system begins to scan for the Wireless Headset. A list of Bluetooth® devices within range of your PS3™ system will be displayed.
5. Select the Wireless Headset from the list of displayed devices. If prompted for a pass key, enter "0000". The headset is now paired with the PS3™ system.

USING THE WIRELESS HEADSET WITH WIRELESS CONTROLLERS

After pairing the Wireless Headset with the PS3™ system, a maximum of four wireless controllers can be used.

PAIRING THE WIRELESS HEADSET WITH A MOBILE PHONE

1. Press and hold the power button on the Wireless Headset until the power indicator flashes alternately in green and red, indicating that Bluetooth® Discovery Mode is enabled.
2. Turn on the Bluetooth® feature on your mobile phone and start scanning for the headset.
3. Select the Wireless Headset from the list of displayed devices.
If prompted for a pass key, enter “0000”.
The headset is now paired with the mobile phone.

NOTE: See your mobile phone's instruction manual for further information on activating the phone's Bluetooth® functionality.

TURNING THE WIRELESS HEADSET ON AND OFF

To turn on the Wireless Headset:

Press and hold the power button for approximately three seconds. The power indicator will be lit in solid green for two seconds to indicate that the headset is turned on.

To turn off the Wireless Headset:

Press and hold the power button for at least five seconds, until the power indicator begins to flash green to indicate that the headset is turning off.

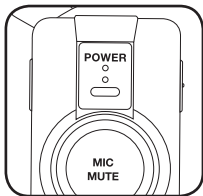

WEARING THE WIRELESS HEADSET

1. Gently push open the ear clip.
2. While holding the ear clip open, slide it behind your ear.
3. Adjust the headset until it fits comfortably on your ear.
 - 3a. The ear clip shape is adjustable. Change the shape of the ear clip to maximise comfort.

NOTE: An additional earpiece ring is included – use the one that feels most comfortable.

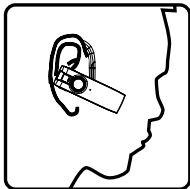
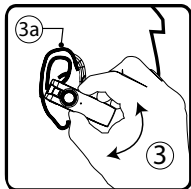
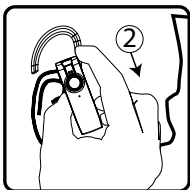
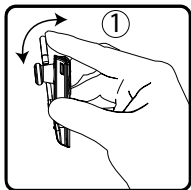

CHANGING FOR USE ON YOUR OTHER EAR

The Wireless Headset is supplied ready to wear on the right ear, but can be worn on either ear.

To adjust for the left ear:

1. Gently pull the bottom of the ear clip off the hinge pin.
2. Flip the clip over so that it is symmetrically opposite from its original position.
3. Hook the bottom of the clip onto the hinge pin.

BASIC OPERATIONS WHEN CONNECTED TO A PS3™ SYSTEM

Operation	Action
Turn on	Press and hold the power button for approximately three seconds
Turn off	Press and hold the power button for at least five seconds
Mute sound	Press the mic muting button
Raise volume	Press the volume + button
Lower volume	Press the volume – button

BASIC OPERATIONS WHEN CONNECTED TO A MOBILE PHONE

Operation	Action
Turn on	Press and hold the power button for approximately three seconds
Turn off	Press and hold down the power button for at least five seconds
Mute the microphone	Press the mic muting button
Raise volume	Press the volume + button
Lower volume	Press the volume – button
Answer a call	Briefly press the power button
Reject a call	Press the power button for two seconds
End a call or cancel an outgoing call	Briefly press the power button
Transfer a call from headset to phone	Press the power button for two seconds
Transfer a call from phone to headset	Press the power button for two seconds
Redial the last number	Press the power button for two seconds

NOTE: For additional operating information please refer to the full User Manual available at eu.playstation.com

SPECIFICATIONS

Bluetooth® version	Bluetooth® 2.0 compliant
Supported Bluetooth® profiles	Bluetooth® headset and hands-free profiles
Operating range	Up to 33 feet (10 metres)
Talk time	Up to 8 hours
Standby time	Approximately 12.5 days or 300 hours
Charging time	Approximately 3 hours
Weight	58g
Battery type	Lithium-ion polymer battery
Voltage	DC 3.7 V
Capacity	190 mAh
Operating temperature	5°C – 35°C (41°F – 95°F)

Design and specifications are subject to change without notice.

LIMITED WARRANTY

Where a 1-year warranty is supplied with your PLAYSTATION®3 system, such warranty also applies to this product. For details, please see the PLAYSTATION®3 Safety and Support Guide, available online at eu.playstation.com/ps3, or call the PLAYSTATION®3 Customer Service number, which can be found within every PLAYSTATION®3 format software manual.



RECYCLING INSTRUCTIONS FOR CUSTOMERS IN EUROPE

For further information, please refer to the PLAYSTATION®3 Safety and Support Guide, available online at eu.playstation.com/ps3



LITHIUM-ION BATTERY IN WIRELESS HEADSET

The Lithium-ion polymer battery included in this product is permanently built-in for safety, performance or data integrity reasons. The battery should not need to be replaced during the lifetime of the product and should only be removed by skilled service personnel. To ensure the correct waste treatment of the battery, please dispose of this product as electrical waste.

©2008 Sony Computer Entertainment Europe.

 PLAYSTATION and PlayStation are registered trademarks of Sony Computer Entertainment Europe.

Manufactured by Namtai under agreement with Sony Computer Entertainment Europe

